

DRC

PZ24-12000027

07/02/2025

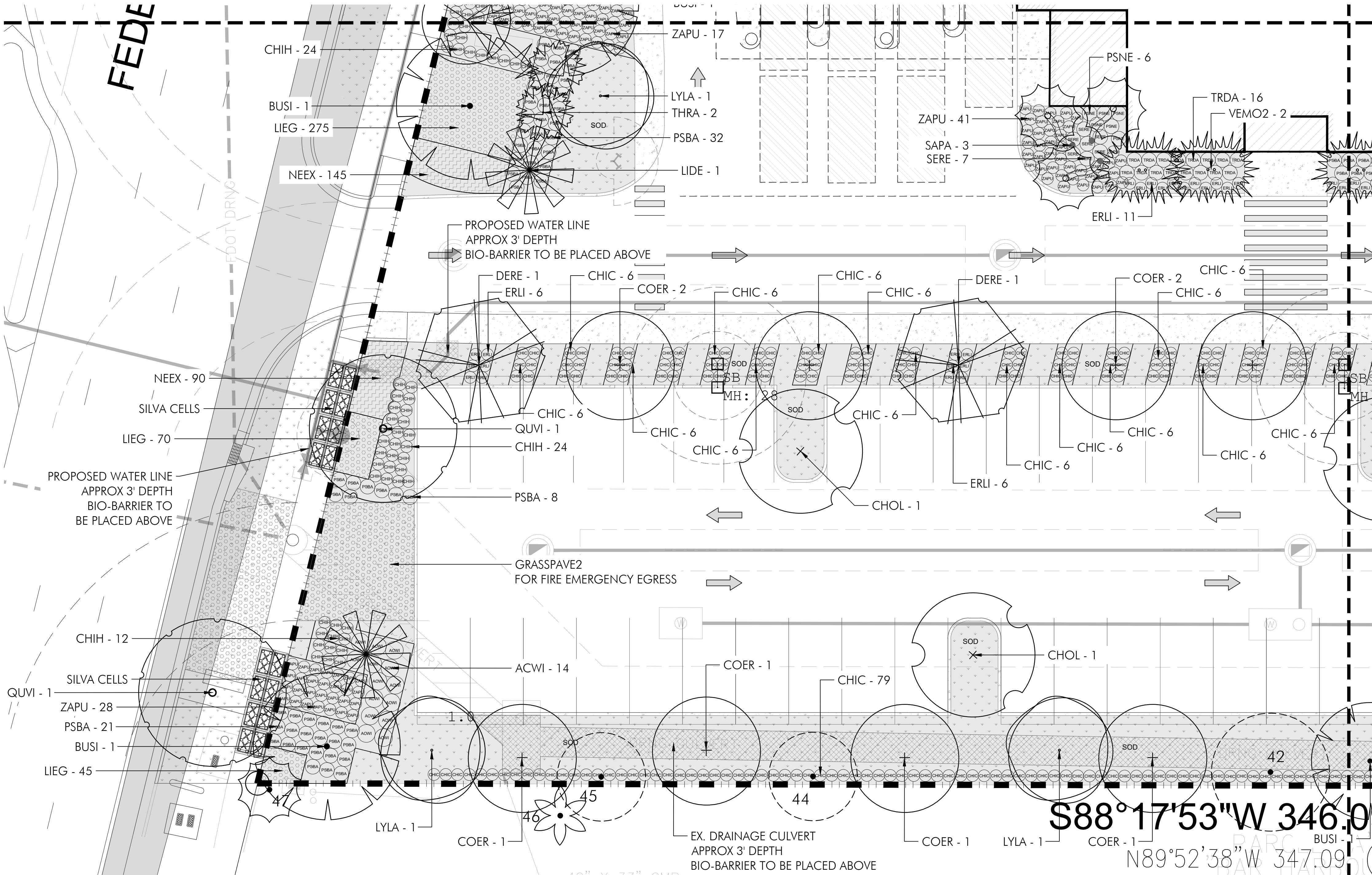

KEY:

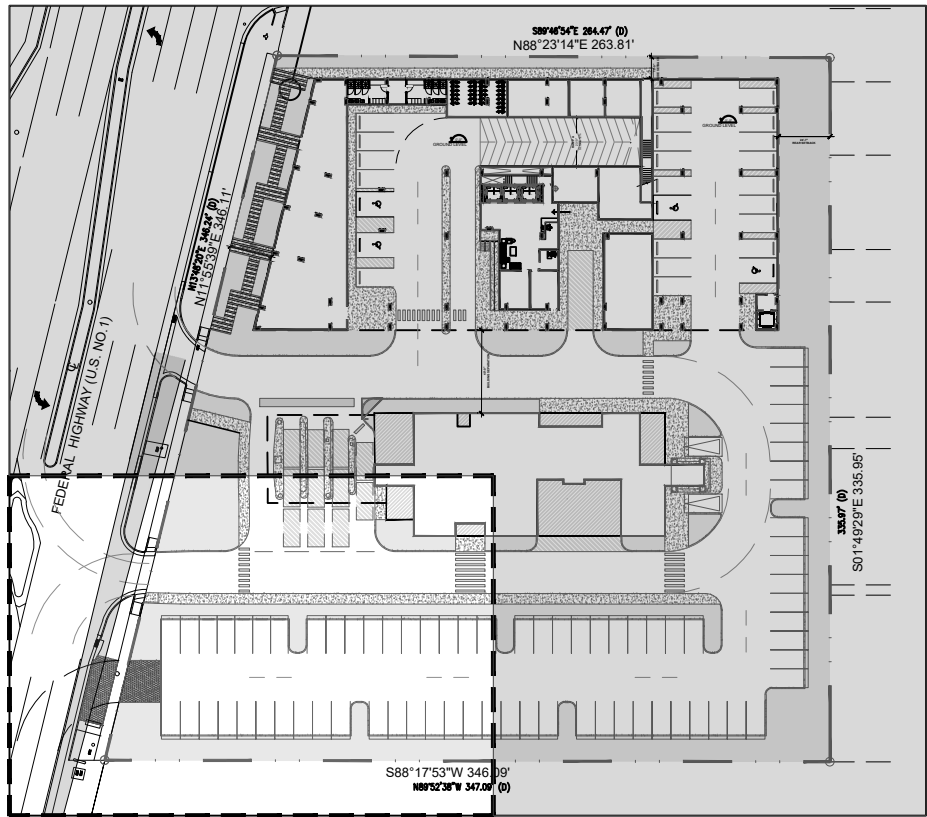

absolute-idea.com

CANAL PARK
3323 NE 163rd Street, Suite 200 North Miami Beach, FL 33160
305.792.0015 305.931.0279 info@absolute-idea.com

SEAL
KEN GARDNER
FLA 1569
TO THE BEST OF MY KNOWLEDGE, THE PLANS AND SPECIFICATIONS COMPLY WITH ALL CITY, COUNTY, STATE AND FEDERAL REQUIREMENTS AND I AM NOT PROVIDING ANY GUARANTEE OR WARRANTY FOR THE DESIGN OR CONSTRUCTION OF THE PROJECT. MY LIABILITY IS LIMITED TO THE DESIGN AND CONSTRUCTION OF THE PROJECT.

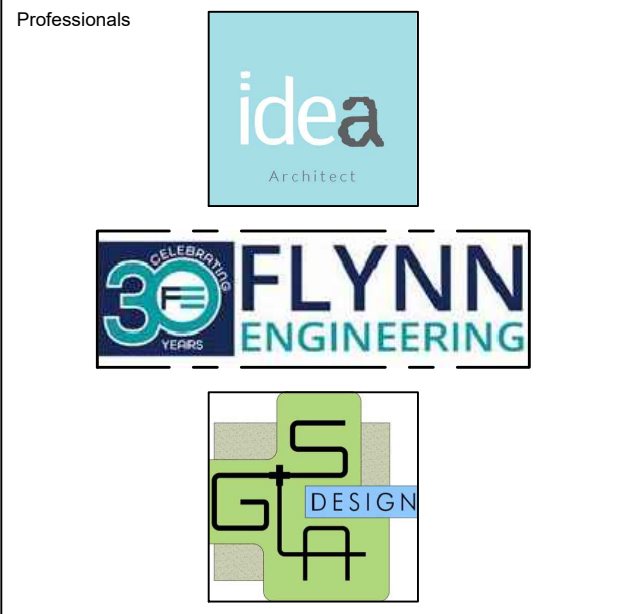

REV.	DATE	DESCRIPTION
01	XX-XX-2024	D.R.C. SUBMITTAL

ALL MEASUREMENTS MUST BE VERIFIED BEFORE BEGINNING THE WORKS. NO MEASUREMENTS ARE TO BE SCALED DIRECTLY FROM THIS DRAWING.

Key section
PROGRESS SET

Client
VERA FUND
NICK POLYUSHKIN
& YURI KHARITONENKOV
TEL: 305.833.3303

Project
**1600 S FEDERAL HIGHWAY
(MIXED-USE PROJECT)**
1600 SOUTH FEDERAL HIGHWAY,
POMPAÑO BEACH, FL 33062

Title PLANTING PLAN GROUND FLOOR	
Drawn GSLA	Field LANDSCAPE ARCH
Verified KG	Scale as shown
Approved KG	Date 10-09-2024
Project Manager KG	Dwg. no. L-203
Project 24-838	

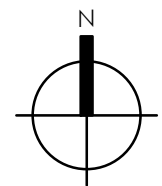

PLANTING PLAN - GROUND FLOOR

